



RD2 Reckless Driver TM by DLS Effects

The **NEW RD2 Reckless Driver** has massive enhancements over the earlier versions. It now incorporates additional Volume and Gain in the Normal & Boost channels, increased sustain, fullness, drive, purer distortion, and wider range Clean-Mix pots that can be blended to achieve clearer more defined tones to taste! Opamps are now driven by higher voltage for power packed drive and extra headroom.

The RD2 is like having many effects in one pedal: Set the Normal channel as a pre-amp, a clean boost, or rhythmic overdrive/distortion. Set the Boost channel as a distortion for biting leads with volume bump, as a breakover overdrive, or simply as a volume boost. The Bass & Treble pots along with the high/low Attack toggle switch give the guitarist the versatility to control all aspects of tone and attack. No matter what setting, the RD2 keeps your original instrument tone intact! *"It's a Clean Boost or Overdrive when you want it, and a Reckless Distortion when you need it!"*

**Many thanks to recording artist, studio guitarist and virtuoso Johnny Hiland for his collaboration to bring this product to the next level!*

Features include:

- **Normal Channel** with added VOLUME, GAIN, and extended clean MIX pot. Use it as a preamp, a clean boost, or overdrive by increasing the GAIN. Green LED lit indicates effect is ON with Normal Channel engaged. (Normal channel similar to a master volume)
- **Boost Channel** with it's own VOLUME, GAIN and wider range clean MIX pot. Use this channel as attacking Distortion, Distortion with volume boost, with clean Mixed in for clearer Distortion, or simply as a 2nd level Volume Boost. (Red LED lit when Boost ON)
- **Boost Switch:** Engages the Boost channel.
- **Bass control:** Full range bass with dynamic response.
- **Treble control:** Wide range treble with dynamic response.
- **Attack switch:** when high attack (switched right), there is slightly more attack and brightness. This subtle setting gives amps more bite, brightness, plus extra edge required to make most solid-state amps sound more like a tube amp.
- **On/Off:** True Bypass switching utilizes high quality 3P3T switch. (no tone sucking when switched Off)
- **IN, OUT:** high quality standard 1/4" Amphenol guitar jacks.
- **Internal "RT1 Drive" pot:** Clockwise increases the Gain of the Normal and Boost channels. (more drive and distortion)
- **Internal "RT2 Gain1" pot:** Adjusts the amount of drive to Stage 1 (counterclockwise harsher-edgier pronounced distortion, clockwise for smother distortion).
- **High Head Room:** Internal voltage charge pumps to 12vdc for higher headroom, clearer preserved tones, and more bite.
- **Power:** Accepts 9vdc to 12vdc input @ 20ma. Standard 2.1mm jack., any polarity!
- **Size:** Extremely compact measuring only 3.7"W x 4.7"L x 1.7"H
- **Case material:** Quality die cast aluminum finished with power coat painting for durable finish.
- **Weight:** Extremely light and compact, weighing only 1.9 lbs.

Wide range Dynamic Treble control

Full range Bass control

Attack:

Right= slightly more attack and brightness
Left= warmer & smoother

Boost:
Switches between Boost and Normal channels

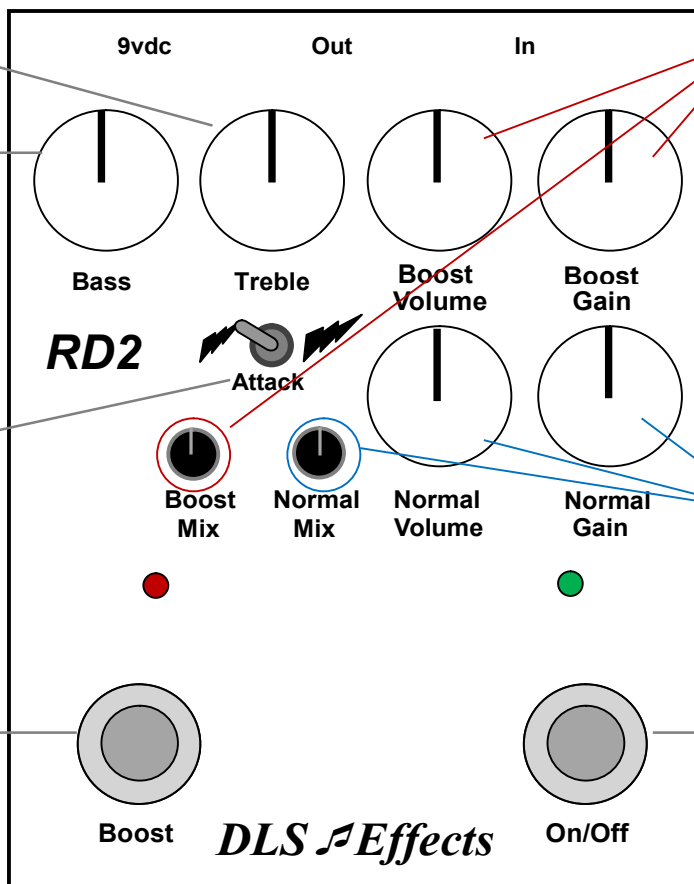

Boost Channel:
Volume, GAIN and Clean Mix

****WARNING****
Fasten your seatbelt before Overdriving! TM

Normal Channel:
Volume, GAIN and Clean Mix

On/Off:
True Bypass, quiet switching

Power:
 9vdc to 12vdc input
 @ 20ma minimum,
 polarity does not matter!
 (Standard 2.1mm jack)

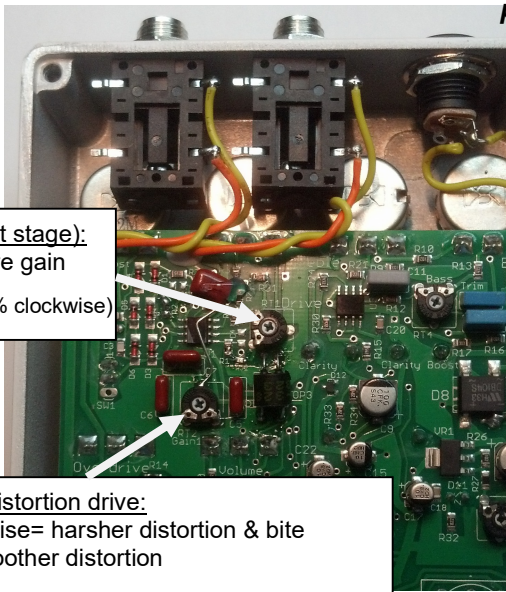

RT1 Drive (Input stage):
 Clockwise= more gain
 (factory set to 80% clockwise)

RT2 Stage1 - Distortion drive:
 Counter Clockwise= harsher distortion & bite
 Clockwise= smoother distortion
 (factory set to 60% clockwise)

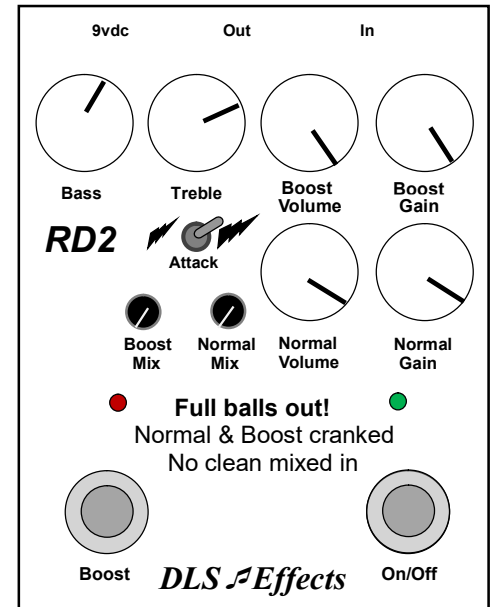
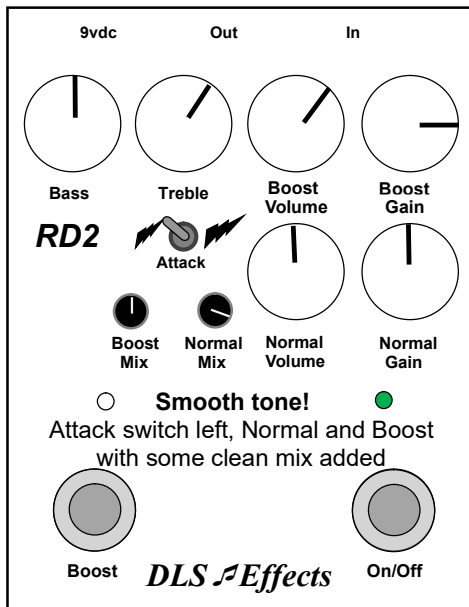
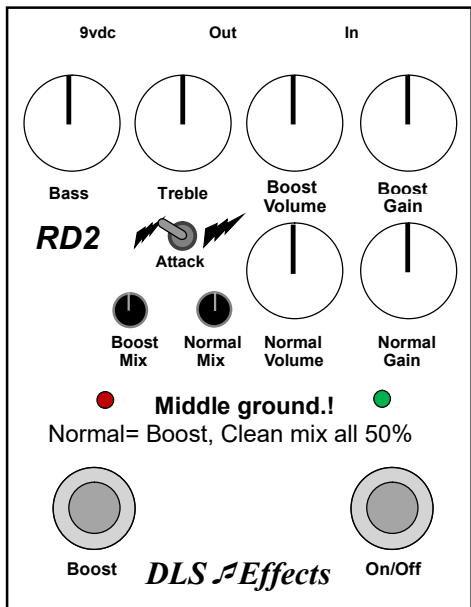
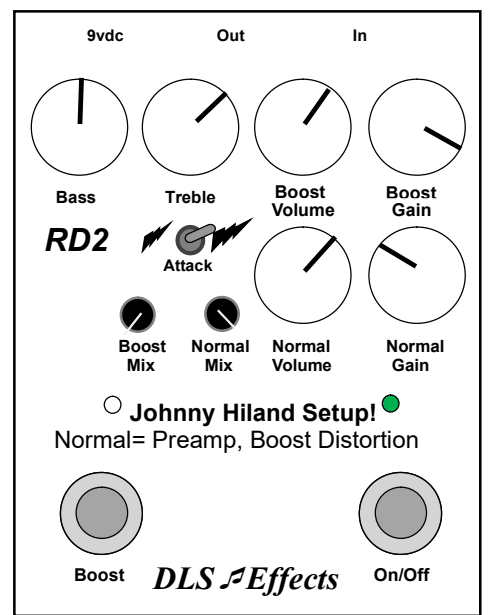
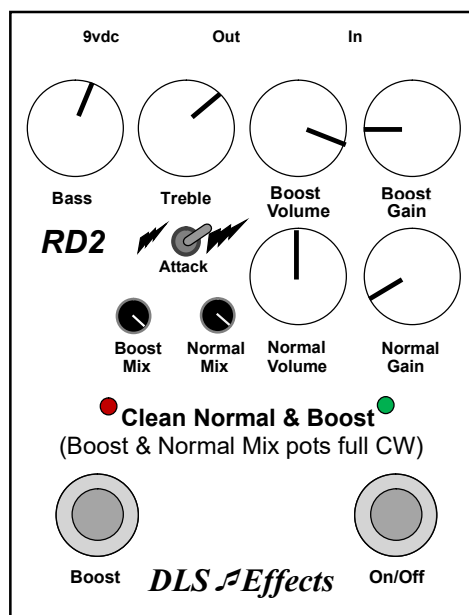
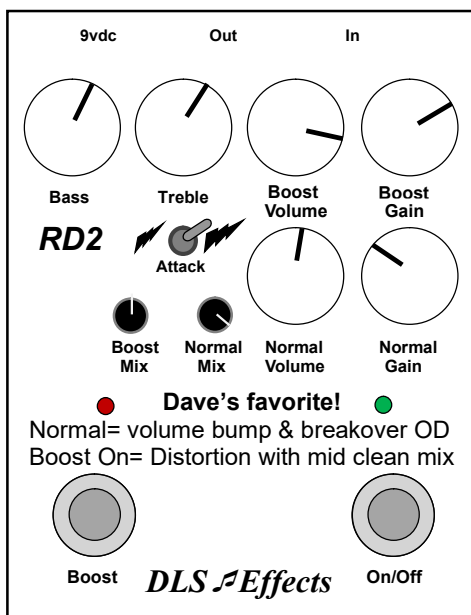
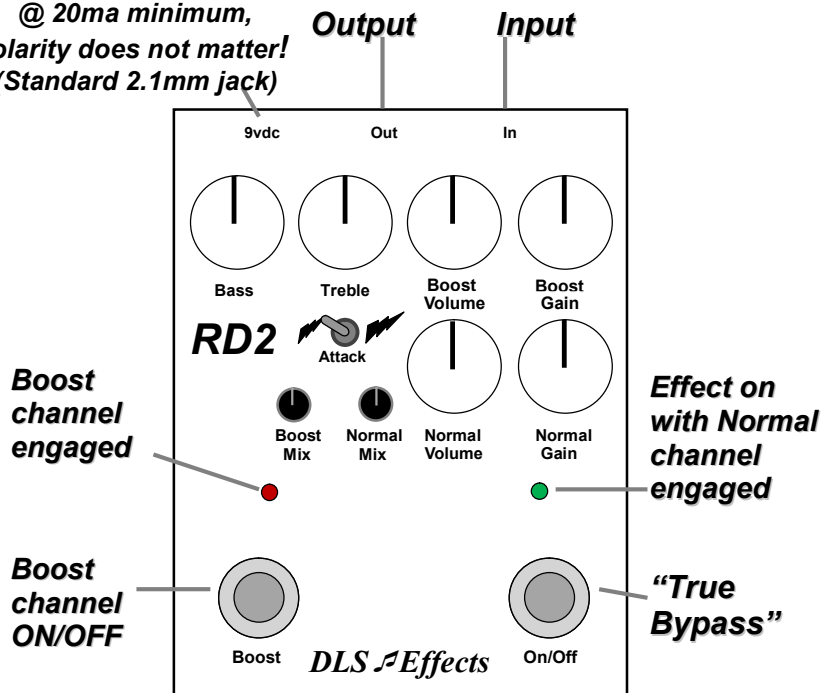

Warning (Please read for your protection).

Moisture & Water concerns:

This product should NOT be used near water or moisture. Care should be taken so that this product does not fall into liquids and liquids are not spilled onto the enclosure. Do not use this product on a wet lawn, by a bathtub or sink, near a laundry basin, in a wet or damp basement, on wet cement, near a swimming pool, etc).

Power:

A transformer or certified instrument power supply is required for this product. If using a transformer, be sure it is UL or ETL safety approved or listed. If excessive heat or burning smell is discovered coming from this product or the transformer, immediately unplug the transformer and the product and contact your dealer. If using a 3rd party instrument power supply, be sure it meets the Power and Voltage requirements called out in the DLS manual. Rout power supply cords so they are not likely to be walked on, pinched, or damaged.

Hookup & Grounding:

Precautions should be taken so that the grounding and power of this or any product are not bypassed or altered. Improper hookup or grounding of this product can cause injury or even death. If there is any question to proper installation and grounding, please contact a qualified electrician or dealer. For hookup information, please consult with a qualified electrician or dealer.

Service:

To reduce the risk of fire, short circuit or shock, the user should not attempt to service this product, open the enclosure, or alter the product or power input. For any servicing requirements, please send this product and power supply to a qualified dealer.

General:

This product should be handled with care to prevent injury. If there is any question or concern about this product or the hookup of this product, contact a qualified electrician or qualified dealer.